

Queen Street

KINGSWOOD

APPROXIMATE FLOOR AREA
79.7 SQM / 857 SQFT



GROUND FLOOR
440 sq.ft. (40.9 sq.m.) approx.

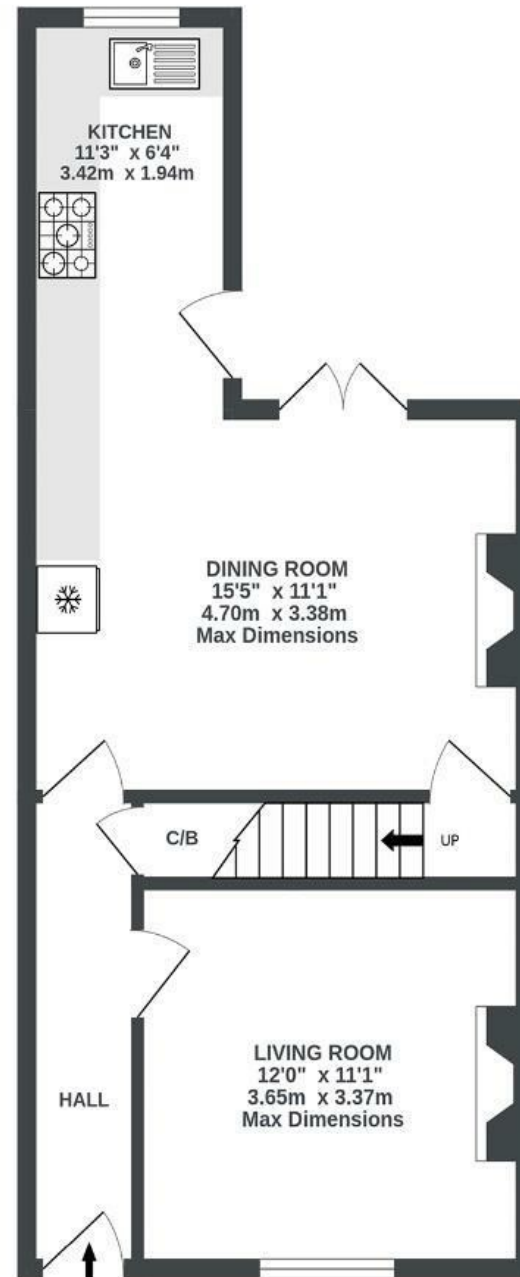

1ST FLOOR
417 sq.ft. (38.8 sq.m.) approx.

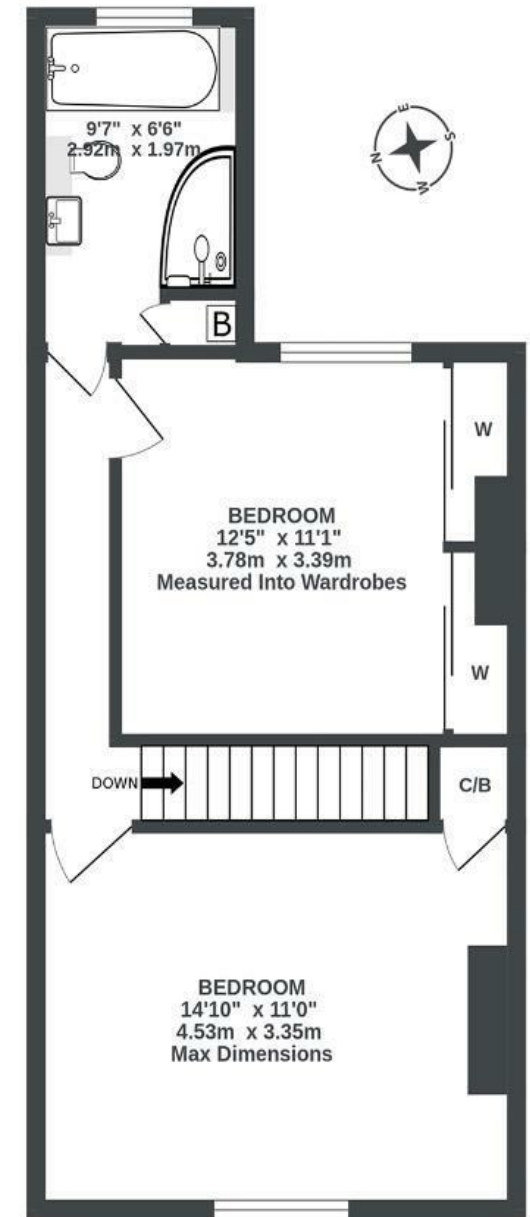

Illustrations are for reference purposes only, measurements are approximate, not to scale.

Boardwalk

Queen Street

KINGSWOOD,

£

£300,000



BS15 8BA

zzz

2 Bedrooms



1 Bathrooms

"The independent shops and cafes of Church Road are a twenty minute walk away, we love visiting the park and going for pizza at The Red Church. The Rose and Crown pub is two minutes walk away and is a really friendly, inviting pub. It does great food and hosts lots of events like a Monday night quiz. We love walking our dog at Troopers Hill or Magpie Bottom."

